

Accessories

Category

Overview

Tackle complexity with technology. The WiFi Interface is the wireless bridge between your laptop, PC, or PDA, and the Stellar family of dimming systems. Through your wireless network, you can adjust scenes and lighting levels, and because you don't have to be tied down to your desk, you can see what's going on with your lighting system as you make changes in real time. And with WiFi networks becoming more prevalent and easier to set up, the WiFi Interface is an easy way to give yourself more control over your lighting system.

Photos

Typical Applications



WiFi Interface - front view

- Offices, media rooms, conference rooms
- Houses of worship
- Auditoriums, meeting halls
- Resorts, country clubs
- Restaurants, lounges, clubs

Features

- Interact with Stellar dimming systems from the comfort of your desk or your couch, without wires
- Establishes a wireless bridge between the dimming system and your wireless network, laptop, or PDA
- Communicate with the WiFi Interface using the Virtual RMS and Virtual RCS software for PC or Pocket PC
- Requires only a four-conductor cable for wiring to the dimmer panel
- Customize the faceplate with your choice of colors, graphics, and type

# WiFi Interface

Accessories

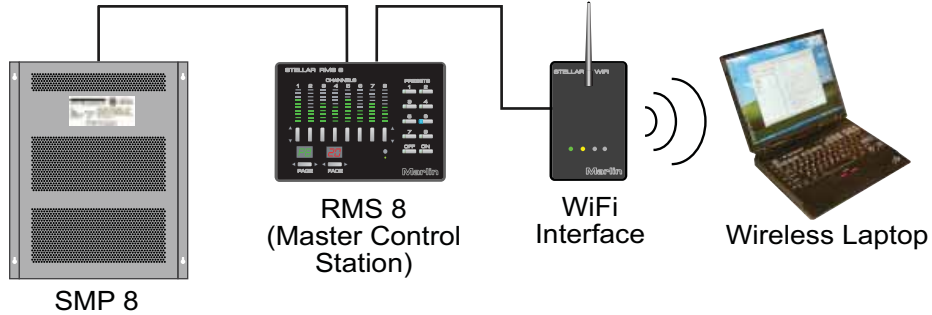

*Stellar Mini Panel with eight dimmers, RMS 8 master control station, and control from a wireless laptop via WiFi Interface*

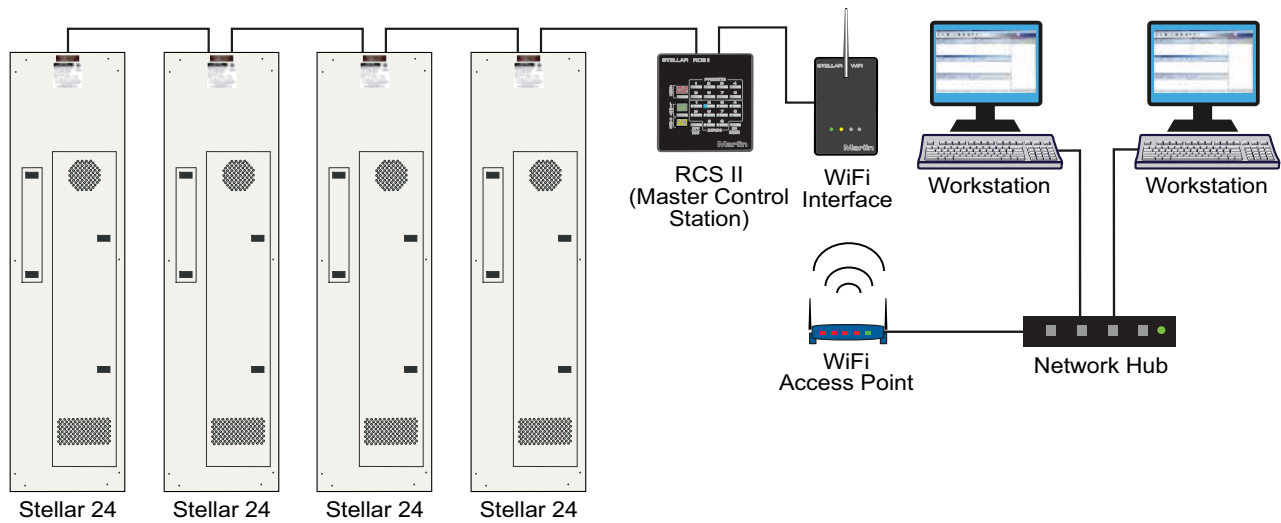

*Four Stellar dimmer panels with 24 dimmers each, RCS II master control station, and WiFi Interface as a bridge to a LAN*

Accessories

Category

Specifications

Front dimensions	2.75" W x 4.50" H
Switch box dimensions	2.0" W x 3.75" H x 3.5" D (1-gang, Raco P/N 695)
Wireless compatibility	Wireless-B (802.11b)
Data rate	11, 5.5, 2, 1 Mbps (depending on signal strength)
IP addressing	Static or DHCP
Operating frequency	2.4 GHz
RF power	+15 dBm
Antenna	5 dBi omnidirectional; higher-gain antenna available
Status indication	LED for power Bicolor LED for WiFi association/user connection
Software	Compatible with Virtual RMS and Virtual RCS software for PC; Pocket RMS software for Pocket PC
Wiring	Requires four-conductor shielded low-voltage control cable, minimum 20-gauge (Belden #9402 recommended)
Input voltage	12 VDC
Communication	RS-485
Faceplate customization	Matte black, laser-engraved acrylic; custom colors, text, and graphics available upon request

\* Information within this document is subject to change without notice.

Custom Colors and Engraving



Vintage Silver



Orange



White



Marble



Blueberry



Brushed Gold



Bordeaux



China Blue



Black



Verge



Ruby



Brushed Aluminum

Switch Box Dimensions

1-gang, Raco P/N 695

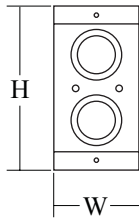

2.0" W x 3.75" H x 3.5" D

2-gang, Raco P/N 696

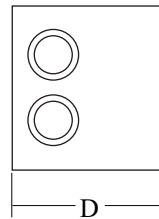

3.75" W x 3.75" H x 3.5" D

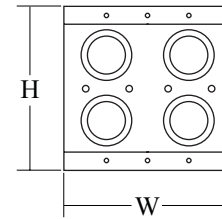

3-gang, Raco P/N 697

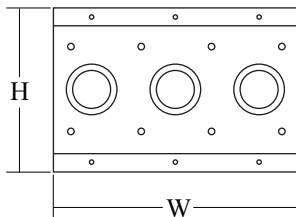

5.625" W x 3.75" H x 3.5" D

4-gang, Raco P/N 698

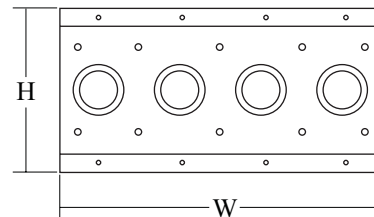
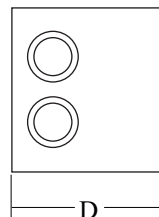

7.5" W x 3.75" H x 3.5" D

\* Information within this document is subject to change without notice.

© Copyright 2007 Marlin Controls, Inc. All rights reserved.